



BALDOR® • *RELIANCE*

Product Information Packet

CWAM3557

1.5HP, 1140RPM, 3PH, 60HZ, 56, C, 3528M, TEFC, F

Product Detail							
Revision:	F	Status:	PRD/A	Change #:		Proprietary:	No
Type:	AC	Prod Type:	3528M	Elec. Spec:	35WG1273	CD Diagram:	CD0005
Enclosure	TEFC	Mfg Plant:		Mech Spec:	35V064	Layout:	35LYV064
Frame:	56C	Mounting:	F1	Poles:	06	Created Date:	08-23-2005
Base:	RG	Rotation:	R	Insulation:	F	Eff. Date:	12-23-2008
Leads:	9#18	Literature:		Elec. Diagram:		Replaced By:	

Nameplate NP2072E							
CAT.NO.	CWAM3557						
SPEC.	35V064-1273						
HP	1.5						
VOLTS	230/460						
AMP	5/2.5						
RPM	1140						
FRAME	56C	HZ	60	PH	3		
SER.F.	1.00	CODE	F	DES	B	CL	F
NEMA-NOM-EFF	75.5	PF	68				
RATING	40C AMB-CONT						
CC				USABLE AT 208V			
DE	6205	ODE	6203				
ENCL	TEFC	SN					

Parts List			
Product ID	Description	Quantity	List Price
SA132447	SA 35V064-1273	1.000	577.00
RA122378	RA 35V064-1273	1.000	481.00
NS2512A01	INSULATOR, CONDUIT BOX X X	1.000	2.00
35CB1001A01A	CONDUIT BOX, W/AUTOPHORETIC PRIMER	1.000	25.00
35GS1022A02	GASKET BOX .06 THK NEOP BLK HDN 30-40 DU	1.000	2.00
51XB1016A07	10-16 X 7/16 HXWSSLD SERTYB	2.000	2.00
11XW1032G06	10-32 X .38, TAPTITE II, HEX WSHR SLTD U	1.000	3.00
HW3001A01	D3019 BRASS WASHER(STIMP)	1.000	2.00
35EP1100B60A	FRONT TEFC 203 BRG WD3 W/ SEAL (AUTOPHOR	1.000	53.00
HW4606A01	JM CLIPPER/SEAL (WDE-0667-1064-BH49)	1.000	45.00
HW4500A33	1/8 NPT STAINLESS,HOLO-KROME #13002,PRES	3.000	3.00
HW5100A03SP	WAVY WASHER (W1543-017)	1.000	2.00
35EP1300A95A	PULLEY 143-5TC ENCL 205 BRG WD3 W/ AUTOP	1.000	218.00
HW4500A33	1/8 NPT STAINLESS,HOLO-KROME #13002,PRES	3.000	3.00
HW4606A02	JM CLIPPER/SEAL (LWE-0938-1624-AL23)	1.000	46.00
12XN1032S20	10-32 X 1-1/4 HEX M.S. , STAINLESS STEEL	2.000	3.00
51XB1214A16	12-14X1.00 HXWSSLD SERTYB	1.000	2.00
35FH4005A01SP	IEC FH NO GREASER W/AUTOPHORETIC PRIMER	1.000	23.00
10XN1032S08	10-32X1/2 HEX HEAD S STL	3.000	2.00
35CB4516	CONDUIT BOX LID, AUTOPHORETIC	1.000	3.00
36GS1002	GASKET, 1/16" NEOPRENE CONDUIT BOX LID	1.000	2.00
59XW0832S07	TAPTITE II,HEX WSHR UNSLTD SER,410 S.S.,	4.000	2.00
HW2502D13	SS KEY, 3/16 SQ X 1.375	1.000	2.00
HA7000A04	KEY RETAINER 0.625 DIA SHAFTS	1.000	2.00

Parts List (continued)			
Product ID	Description	Quantity	List Price
MJ5001A02	732 CL SEALANT 3 OZ DIXIE BEARING 289100	0.001	23.00
MG1025A01	PAINT, 770.02 WILKOFAS CLEAR EPOXY	0.010	338.00
10XF0440S02	04-40 X 1/8 TYPE F HEX HD STAINLESS STIC	2.000	2.00
LB1164	LABEL,WARNING AND DRAIN F/HOSE DOWN	1.000	2.00
MJ5001A23	P.D. GEORGE 494 AIR DRY INSULATING VARNI	0.001	
MJ1000A02	GREASE, POLYREX EM EXXON	0.050	10.00
35FN3002A05SP	EXTERNAL FAN, PLASTIC, FOR .637 DIA JOUR	1.000	22.00
HA3100S07	THRUBOLT 10-32 X 8.375 SS	4.000	3.00
LB1125C01	STD (STOCK) CARTON LABEL BALDOR WITH FLA	1.000	2.00
LC0005	CONN.DIA.,TYPE M,9-LD,DUAL VOLTAGE,REVER	1.000	2.00
NP2072E	NAMEPLATE,SEVER DUTY XT	1.000	
36PA1000	PACK GROUP W/LB5001	1.000	17.00

Performance Data at 460V, 60Hz, 1.5HP (Typical performance - Not guaranteed values)

General Characteristics							
Full Load Torque:	7.0 LB-FT			Start Configuration:	DOL		
No-Load Current:	1.4 Amps			Break-Down Torque:	18.0 LB-FT		
Line-line Res. @ 25°C.:	16.9 Ohms A Ph / 0.0 Ohms B Ph			Pull-Up Torque:	13.5 LB-FT		
Temp. Rise @ Rated Load:	100°C			Locked-Rotor Torque:	16.0 LB-FT		
Temp. Rise @ S.F. Load:	115°C			Starting Current:	10.6 Amps		
Load Characteristics							
% of Rated Load:	25	50	75	100	125	150	S.F.
Power Factor:	34.0	54.0	67.0	75.0	80.0	83.0	78.0
Efficiency:	67.8	77.1	78.4	76.8	73.2	67.1	74.6
Speed:	1185.0	1168.0	1149.0	1125.0	1093.0	1044.0	1106.0
Line Amperes:	1.5	1.7	2.0	2.5	3.0	3.8	2.8

Performance Graph at 460V, 60Hz, 1.5HP (Typical performance - Not guaranteed values)

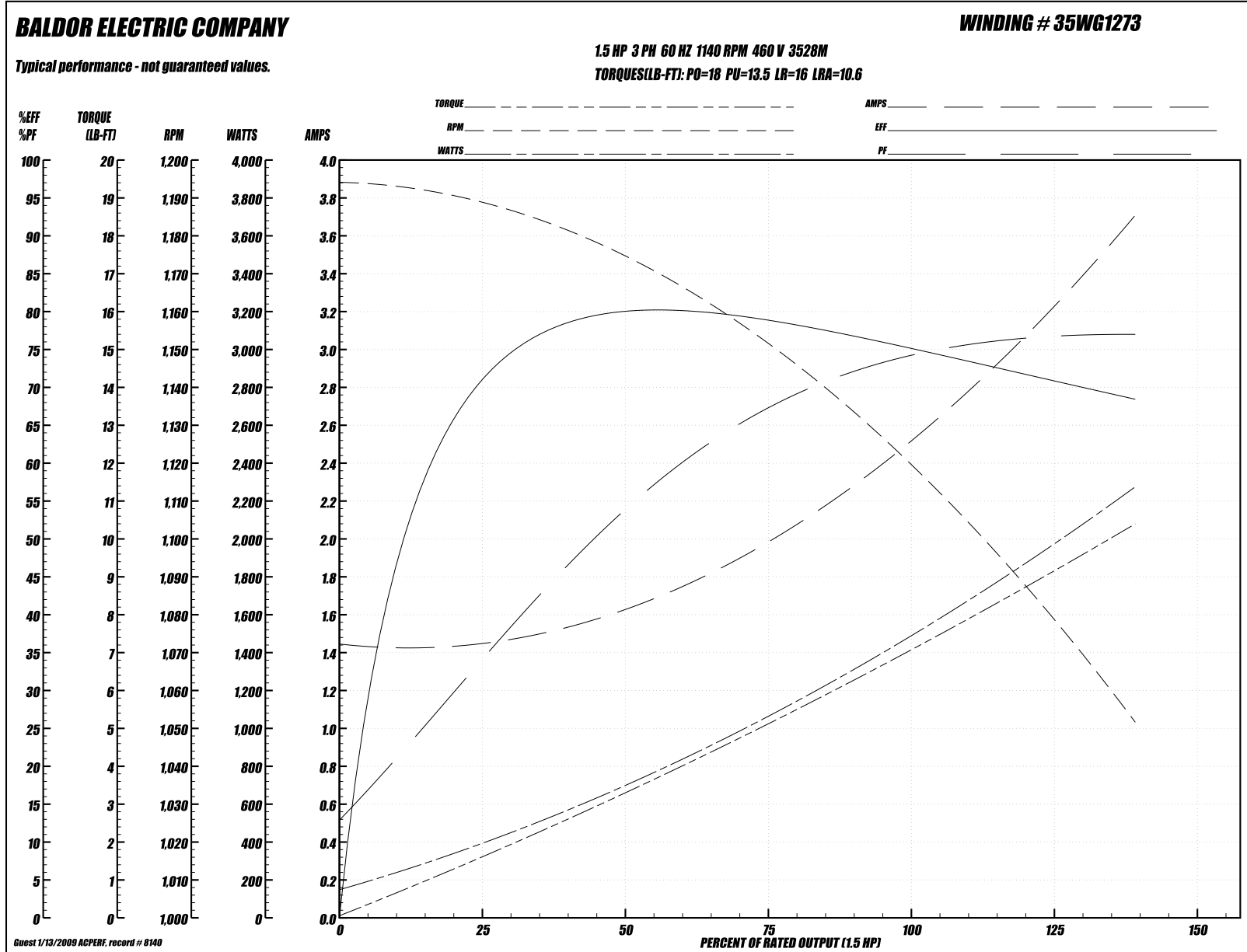

35LYV064

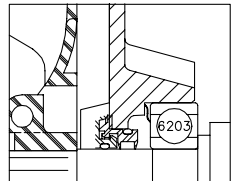
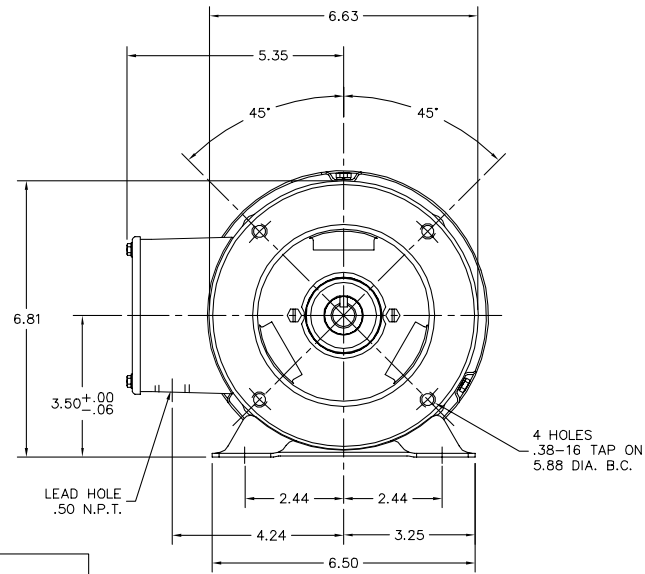
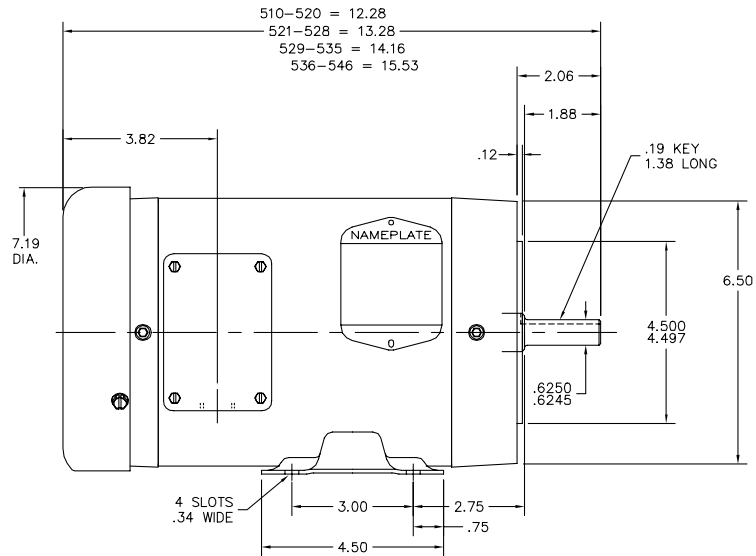

FRONT END DETAIL

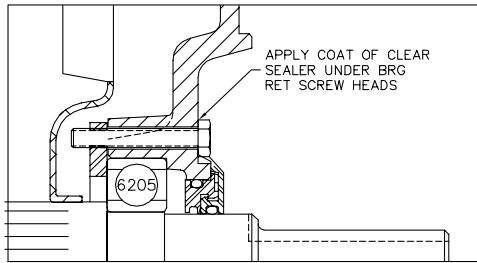

PULLEY END DETAIL

CUSTOMER IS RESPONSIBLE FOR DETERMINING THAT MOTOR PERFORMANCE IS SUITABLE IN THE APPLICATION.

REV. DESC: CONDUIT BOX LID WAS 36CB4514A		
REV. LTR: A	VERSION: 01	TDR: 000000449976
FILE: \AAA\00126\558	REVISED: 13:38:07 11/29/2007	BY: ENBRYPO
MTL: -		

BALDOR • DODGE • RELIANCE

HORZ 56C TEFC M WD3 (S/P009-003-000)

35LYV064

CD0005

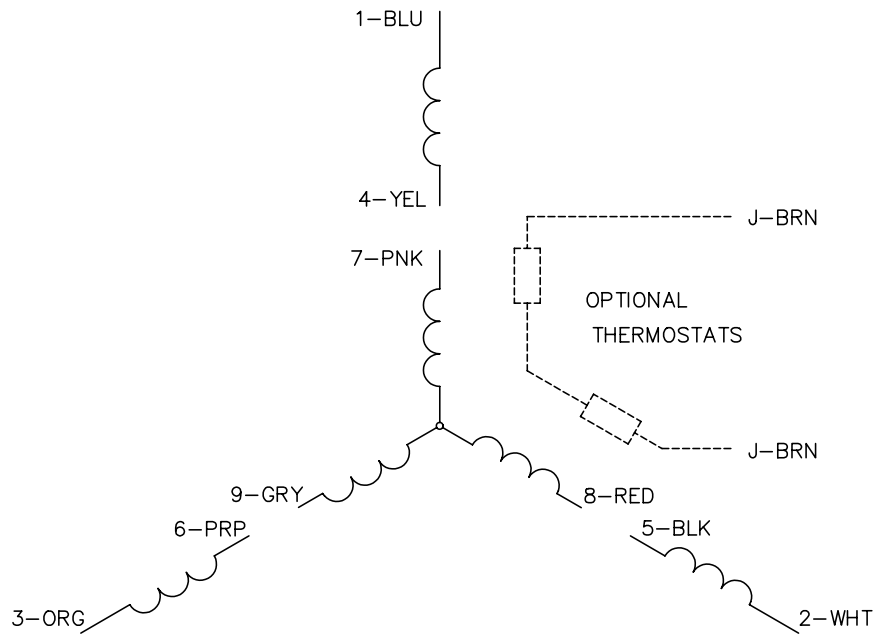

LOW VOLTAGE
(2Y)

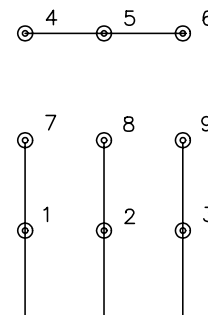

LINE

HIGH VOLTAGE
(1Y)

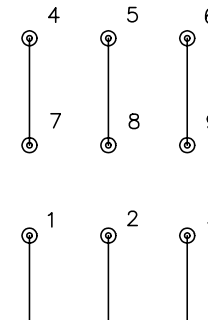

LINE

NOTES:

1. INTERCHANGE ANY TWO LINE LEADS TO REVERSE ROTATION.
2. OPTIONAL THERMOSTATS ARE PROVIDED WHEN SPECIFIED.
3. ACTUAL NUMBER OF INTERNAL PARALLEL CIRCUITS MAY BE A MULTIPLE OF THOSE SHOWN ABOVE.
4. LEAD COLORS ARE OPTIONAL. LEADS MUST ALWAYS BE NUMBERED AS SHOWN.

REV. DESC: REVISE TO SHOW OPTIONAL COLORS			
REV. LTR: E	BY: JLP	REVISED: 01/19/99 10:15	TDR: 0171435
90000		FILE: AAA00005140	MDL: -
		MTL: -	

BALDOR ELECTRIC Co.

3PH, DV, 9 LEADS

CD0005