



BALDOR® • *RELIANCE*

Product Information Packet

CWAM3711T

10HP,3500RPM,3PH,60HZ,215,TC,3732M,TEFC

Product Detail									
Revision:	F	Status:	PRD/A	Change #:		Proprietary:	No		
Type:	AC	Prod Type:	3732M	Elec. Spec:	37WGT223	CD Diagram:	CD0005		
Enclosure	TEFC	Mfg Plant:		Mech Spec:	37J961	Layout:	37LYJ961		
Frame:	215TC	Mounting:	F1	Poles:	02	Created Date:	08-24-2005		
Base:	RG	Rotation:	R	Insulation:	F	Eff. Date:	12-23-2008		
Leads:	9#14	Literature:		Elec. Diagram:		Replaced By:			
Nameplate NP2072E									
CAT.NO.	CWAM3711T								
SPEC.	37J961T223H1								
HP	10								
VOLTS	208-230/460								
AMP	25-23/11.5								
RPM	3500								
FRAME	215TC	HZ			60	PH	3		
SER.F.	1.15	CODE			H	DES	B	CL	F
NEMA-NOM-EFF	89.5	PF			91				
RATING	40C AMB-CONT								
CC	010A	USABLE AT 208V			25				
DE	6307	ODE			6206				
ENCL	TEFC	SN							

Parts List			
Product ID	Description	Quantity	List Price
SA132533	SA 37J961T223H1	1.000	1,057.00
RA122461	RA 37J961T223H1	1.000	881.00
36FN3000C02		1.000	15.00
S/P101-000-000	EPACT PROCEDURES-FS PLANT-POLYREX EM, NO	1.000	
HW3200A01	3/8-16X3/4 I-BLT WELDED F/S	1.000	3.00
37CB1000A17A	37 KOBX W/ .75 NPT @ 6: W/ AUTOPHORETIC	1.000	50.00
37GS1016B01	SANTOPRENE KOBX GASKET W/LIP (BLACK)	1.000	7.00
51XW2520A12	.25-20 X .75, TAPTITE II, HEX WSHR SLTD	2.000	2.00
11XW1032G06	10-32 X .38, TAPTITE II, HEX WSHR SLTD U	1.000	3.00
HW3001A01	D3019 BRASS WASHER(STIMP)	1.000	2.00
37EP1100C05A	FRONT TEFC 206 BRG WD3 W/ CLIPPER (AUTOP	1.000	231.00
HW4606A03	JM CLIPPER/SEAL (LWE-1156-1875-AL44)	1.000	41.00
HW4500A33	1/8 NPT STAINLESS,HOLO-KROME #13002,PRES	3.000	3.00
HW5100A06	W2420-025 WVY WSHR (WB)	1.000	2.00
37EP1300A95A	PULLEY 213-5TC ENCL 307 BRG WD3 W/ AUTOP	1.000	357.00
HW4606A04	JM CLIPPER/SEAL (LWE-1376-2125-AL45)	1.000	43.00
HW4500A33	1/8 NPT STAINLESS,HOLO-KROME #13002,PRES	3.000	3.00
10XN2520S28	1/4-20X 1 3/4 HEX HD SS X	4.000	1.00
XY3118S12	5/16-18 HEX NUT, STAINLESS STEEL	4.000	2.00
51XB1214A20	12-14X1.25 HXWSSLD SERTYB	1.000	2.00
07FH4011	WASHDOWN IEC FH W/AUTOPHORETIC PRIMER	1.000	18.00
10XN1032S08	10-32X1/2 HEX HEAD S STL	3.000	2.00
36CB4518	36 LIPPED CB LID AUTOPHORETIC	1.000	3.00
37GS1003SP	1/16 NEOPRENE GASKET-BLACK, CONDUIT BOX	1.000	6.00

Parts List (continued)			
Product ID	Description	Quantity	List Price
59XN0832S07	8/32 X 7/16 HX WS HD SER X	4.000	2.00
HW2502F21	#303 SS,SQ KEY 5/16 X 2.375	1.000	6.00
HA7000A02	KEY RETAINER RING, 1 1/8 DIA, 1 3/8 DIA	1.000	2.00
MJ5001A02	732 CL SEALANT 3 OZ DIXIE BEARING 289100	0.001	23.00
MG1025A01	PAINT, 770.02 WILKOFAS CLEAR EPOXY	0.010	338.00
10XF0440S02	04-40 X 1/8 TYPE F HEX HD STAINLESS STIC	2.000	2.00
LB1115	LABEL,LIFTING DEVICE (ON ROLLS0	1.000	2.00
LB1164	LABEL,WARNING AND DRAIN F/HOSE DOWN	1.000	2.00
MJ5001A23	P.D. GEORGE 494 AIR DRY INSULATING VARNI	0.001	
MJ1000A02	GREASE, POLYREX EM EXXON	0.050	10.00
HA3104S14	THRUBOLT 12.125LG SS	4.000	13.00
LB1125C04	STD-E (STOCK CTN LABEL STD-E WITH FLAG)	1.000	2.00
LC0005	CONN.DIA.,TYPE M,9-LD,DUAL VOLTAGE,REVER	1.000	2.00
NP2072E	NAMEPLATE,SEVER DUTY XT	1.000	
36PA1001	PACKAGING GROUP	1.000	25.00

Performance Data at 208V, 60Hz, 10.0HP (Typical performance - Not guaranteed values)
General Characteristics

Full Load Torque:	15.1 LB-FT	Start Configuration:	DOL
No-Load Current:	4.87 Amps	Break-Down Torque:	51.2 LB-FT
Line-line Res. @ 25°C.:	0.246 Ohms A Ph / 0.0 Ohms B Ph	Pull-Up Torque:	19.5 LB-FT
Temp. Rise @ Rated Load:	73°C	Locked-Rotor Torque:	25.7 LB-FT
Temp. Rise @ S.F. Load:	84°C	Starting Current:	148.0 Amps

Load Characteristics

% of Rated Load:	25	50	75	100	125	150	S.F.
Power Factor:	81.0	92.0	91.0	92.0	90.0	87.0	91.0
Efficiency:	86.9	90.5	90.8	89.9	88.3	86.8	88.9
Speed:	3571.0	3535.0	3499.0	3458.0	3414.0	3364.0	3432.0
Line Amperes:	7.55	12.6	18.8	25.0	32.1	40.0	29.3

Performance Graph at 208V, 60Hz, 10.0HP (Typical performance - Not guaranteed values)

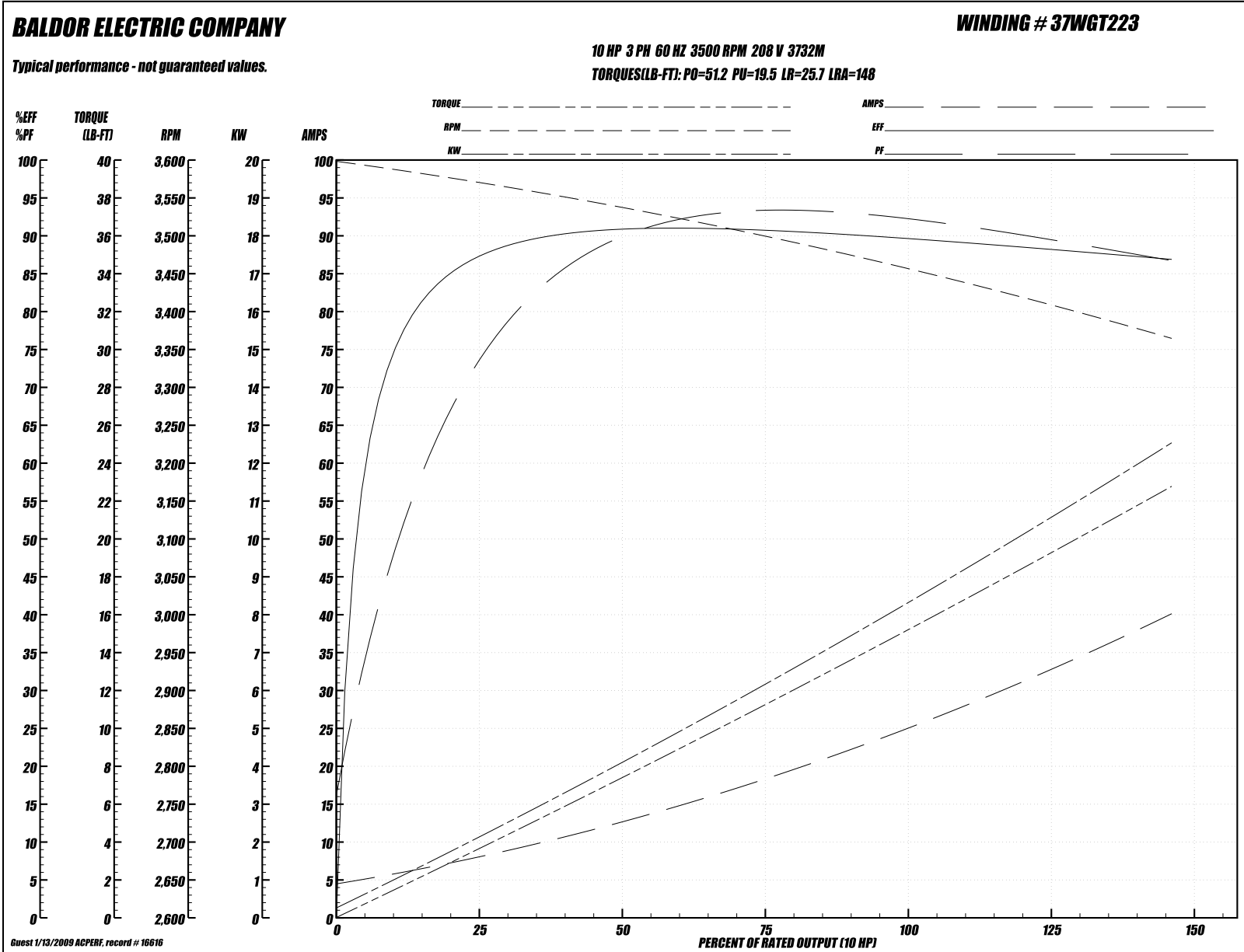

Performance Data at 460V, 60Hz, 10.0HP (Typical performance - Not guaranteed values)
General Characteristics

Full Load Torque:	14.9 LB-FT	Start Configuration:	DOL
No-Load Current:	3.16 Amps	Break-Down Torque:	69.6 LB-FT
Line-line Res. @ 25°C.:	0.984 Ohms A Ph / 0.0 Ohms B Ph	Pull-Up Torque:	21.7 LB-FT
Temp. Rise @ Rated Load:	67°C	Locked-Rotor Torque:	31.7 LB-FT
Temp. Rise @ S.F. Load:	84°C	Starting Current:	90.0 Amps

Load Characteristics

% of Rated Load:	25	50	75	100	125	150	S.F.
Power Factor:	61.0	82.0	88.0	90.0	91.0	90.0	91.0
Efficiency:	86.3	90.9	91.2	90.3	89.0	87.3	89.5
Speed:	3575.0	3548.0	3520.0	3487.0	3453.0	3416.0	3467.0
Line Amperes:	3.92	6.06	8.48	11.4	14.3	17.5	13.1

Performance Graph at 460V, 60Hz, 10.0HP (Typical performance - Not guaranteed values)

BALDOR ELECTRIC COMPANY

WINDING # 37WGT223

Typical performance - not guaranteed values.

10 HP 3 PH 60 HZ 3500 RPM 460 V 3732M

TORQUES(LB-FT): P0=69.6 PU=21.7 LR=31.7 LRA=90

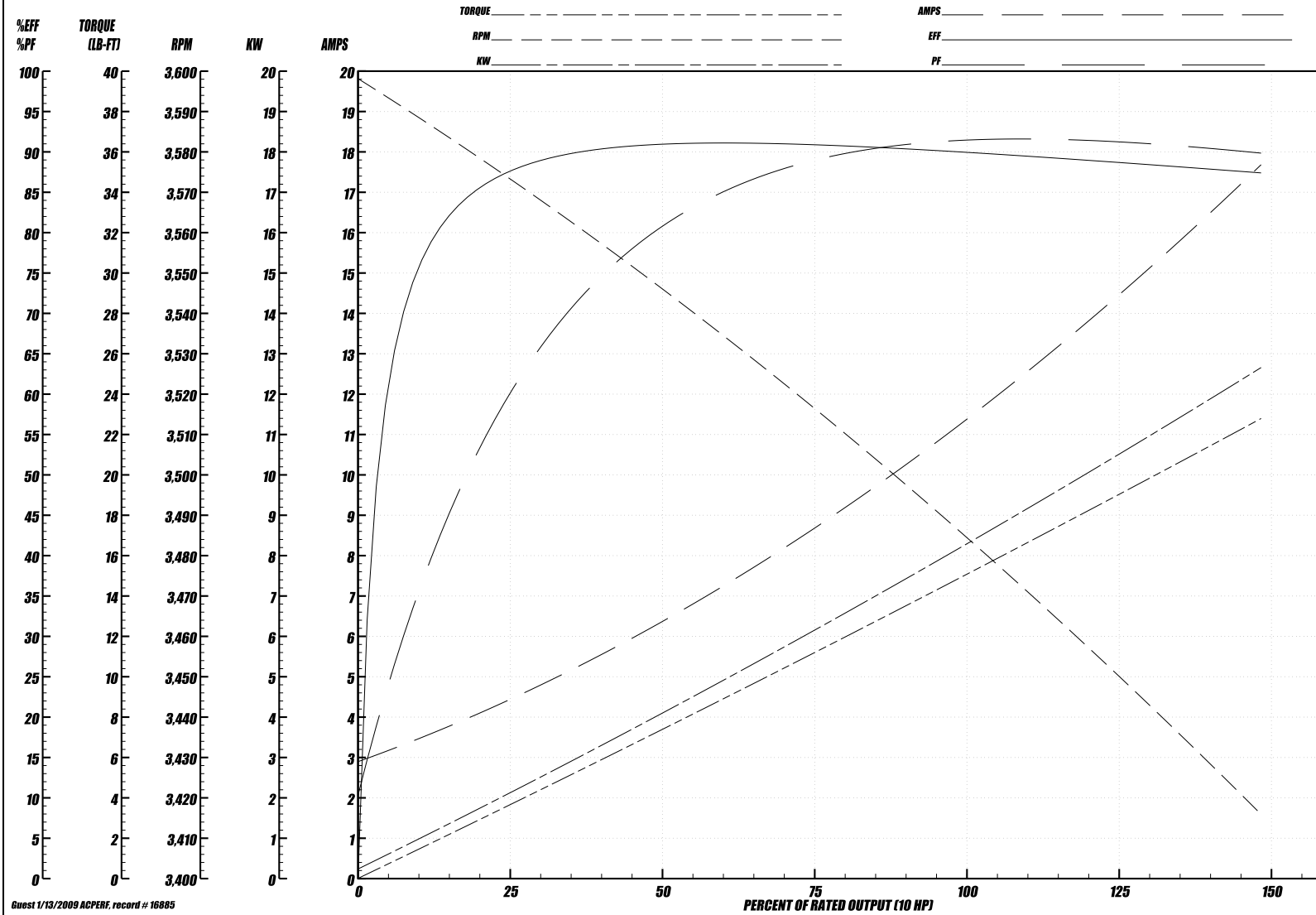

37LYJ961

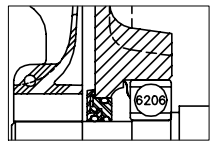
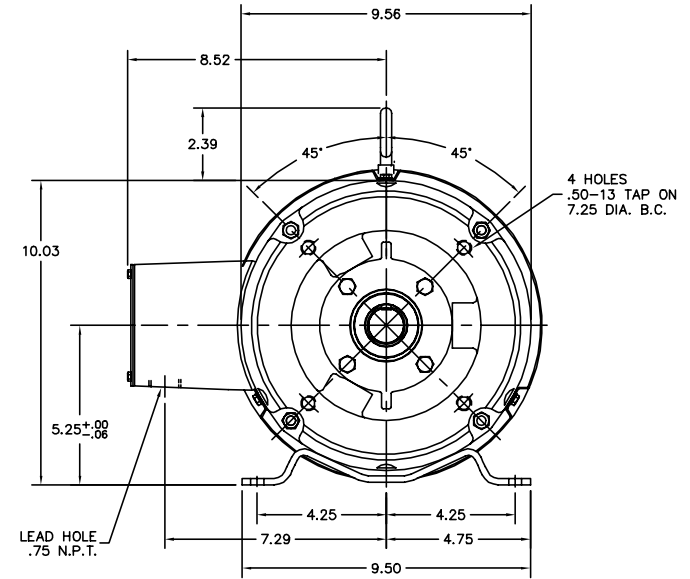
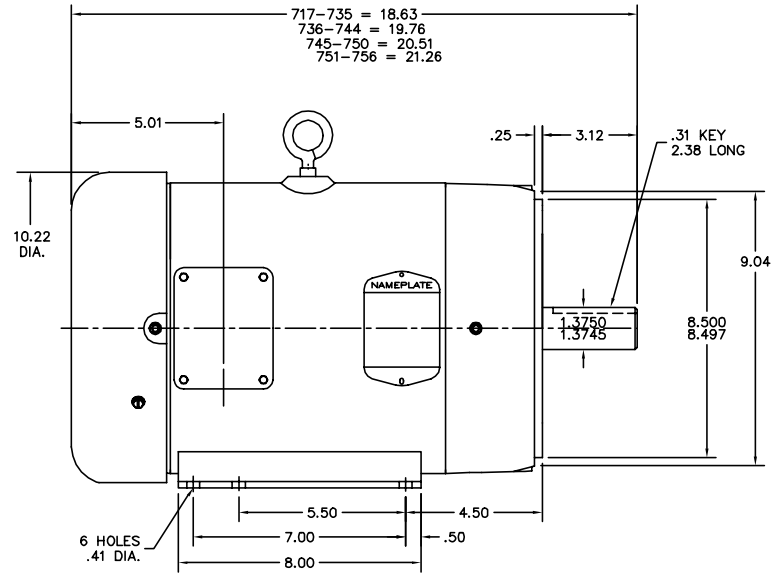

FRONT END DETAIL

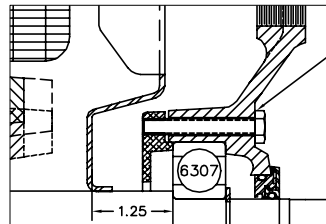

PULLEY END DETAIL

CUSTOMER IS RESPONSIBLE FOR DETERMINING THAT MOTOR PERFORMANCE IS SUITABLE IN THE APPLICATION.

REV. DESC: NEW				TDR: 310969
REV. LTR: -	BY: BGM	REVISED: 10:34:51 10/10/2003		
FILE: AAA00109488				REF: 37LYJ961
MTL: -				

BALDOR ELECTRIC Co.

STD HORZ 213-5TC 37M WD3 (S/P #9-3) W/ EPACT SHOVE

37LYJ961

CD0005

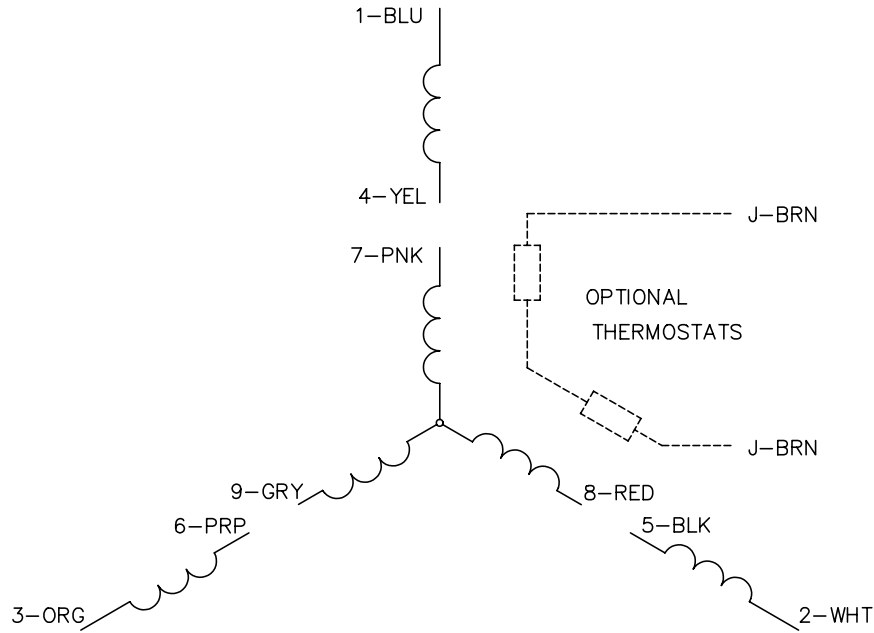

LOW VOLTAGE
(2Y)

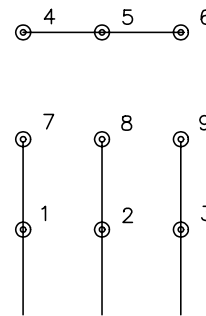

LINE

HIGH VOLTAGE
(1Y)

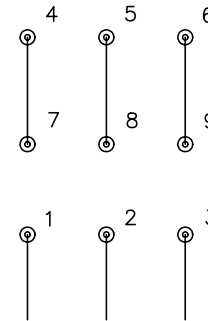

LINE

NOTES:

1. INTERCHANGE ANY TWO LINE LEADS TO REVERSE ROTATION.
2. OPTIONAL THERMOSTATS ARE PROVIDED WHEN SPECIFIED.
3. ACTUAL NUMBER OF INTERNAL PARALLEL CIRCUITS MAY BE A MULTIPLE OF THOSE SHOWN ABOVE.
4. LEAD COLORS ARE OPTIONAL. LEADS MUST ALWAYS BE NUMBERED AS SHOWN.

REV. DESC: REVISE TO SHOW OPTIONAL COLORS

REV. LTR: E BY: JLP

REVISED: 01/19/99 10:15

TDR: 0171435

9000D

FILE: AAA00005140

MDL: -

MTL: -

BALDOR ELECTRIC Co.

3PH, DV, 9 LEADS

CD0005