



BALDOR® • *RELIANCE*

Product Information Packet

ECP84104T-4

30HP,1765RPM,3PH,60HZ,286T,TEFC,FOOT

Product Detail			
Model Number:	ECP84104T-4	Environment:	Harsh / Mill & Chemical
Voltage:	460	HP:	30
Rpm:	1765	Efficiency:	Premium (XE)
Phase:	3	Frequency:	60
Inverter Duty:	*	Enclosure:	TEFC
Frame Group:	280	Frame Size:	286T
Features:	Meets IEEE-841	Mounting:	Foot Mounted
Service Factor:	1.15	Enclosure Group:	TEFC
List Price:	3844.00	Price Symbol:	SD
Speed Range:	1201-1800	Insulation Class:	F
Nema Design:	B	Encl Enhancement:	
Catalog Page:	M-23,B	Dimension Sheet:	611760-570
Connection Diagram:	416820-25	Electric Design:	E09085-B-E011
Single HP:	30	Get Notes:	Meets IEEE-841
Revision:		Instruction Manual:	B-3620
Application:	General Purpose	Epact:	Y
Scaled Drawing:	A84409	Obsolete:	N
Last Data Source:	RAG,MADD	Bearing Type:	
Electrical Type:	P	Mounting Pos:	
Ambient:	40	Duty:	CONT
Amps:	36.1	Nominal Eff:	93.6
Kva Code:	G	Power Factor:	83.1
Poles:	04	Weight:	453

611760-570-SH1

DUTY MASTER ALTERNATING CURRENT MOTORS
 SQUIREL-CAGE INDUCTION MOTOR
 ENCLASURE: TOTALLY ENCLOSED CAST IRON CONSTRUCTION
 COOLING: FAN COOLED
 MOUNTING: FOOT
 FRAMES 250T THRU 440TS
 841-XL WITH STANDARD OVERSIZED CONDUIT BOX

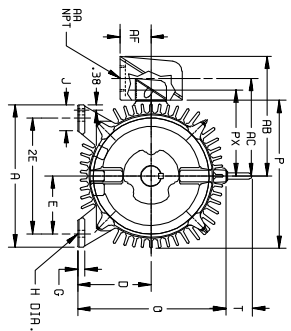
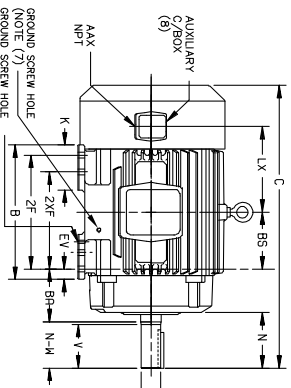

DIMENSIONS ARE IN INCHES. SEE SHEET 2 FOR DIMENSIONS IN MILLIMETERS.

FRAME	A	D(2)	E	G	H	J	K	O	P	T	AA	AB	AC	AF	BA	EV	AUX C/BOX (B)	AX	UX
254T-256T	12.50	5.00	.75	5.61	2.50	---	13.25	13.25	2.44	1-1/4	10.81	8.81	2.50	4.25	1.00	3/4	7.06	9.31	
284T-286TS	13.75	7.00	5.50	.75	5.61	2.50	---	14.75	14.88	2.44	1-1/2	12.62	10.19	3.00	4.75	1.00	3/4	7.63	10.50
324T-326TS	15.50	8.00	6.25	.88	6.9	2.75	4.50	16.69	17.00	2.44	2	15.44	11.69	3.62	5.25	1.38	3/4	8.75	10.50
364T-365TS	17.00	9.00	7.00	.88	6.9	2.75	3.88	18.50	19.50	2.94	3	18.00	13.81	4.12	5.88	1.38	3/4	9.12	11.62
404T-405TS	19.00	10.00	8.00	1.12	8.1	3.25	4.62	21.31	22.50	2.94	3	19.25	15.06	4.12	6.62	1.13	3/4	9.62	14.44
444T-445TS	21.00	11.00	9.00	1.12	8.1	3.25	5.25	23.38	25.25	3.25	3	22.19	17.44	6.00	7.50	1.25	3/4	11.12	15.25

FRAME	SIZE	C	BS	B	ZF	(4)	N	N-W(6)	U(3)	V	SA	LGTH.	WGT.
254T	24.56	5.00	12.00	---	8.25	4.12	4.00	1.625	3.75	3.75	2.88	3.35	3.35
256T	24.56	5.00	12.00	10.00	---	4.12	4.00	1.625	3.75	3.75	2.88	3.45	3.45
284T	27.44	5.50	13.00	---	9.50	5.00	4.62	1.875	4.38	5.00	3.25	4.75	4.75
284TS	26.06	5.50	13.00	---	9.50	3.62	3.25	1.825	3.00	3.75	1.88	4.75	4.75
286T	27.44	5.50	13.00	11.00	---	5.00	4.62	1.875	4.38	5.00	3.25	4.80	4.80
286TS	26.06	5.50	13.00	11.00	---	5.00	3.25	1.825	3.00	3.75	1.88	4.75	4.75
294T	30.44	6.00	14.75	---	10.50	5.62	5.25	2.125	5.00	5.00	3.88	5.80	5.80
294TS	30.44	6.00	14.75	---	10.50	4.12	3.75	1.875	3.50	5.00	2.00	5.80	5.80
324T	30.44	6.00	14.75	12.00	---	5.62	5.25	2.125	5.00	5.00	3.88	6.30	6.30
324TS	28.94	6.00	14.75	12.00	---	4.12	3.75	1.875	3.50	5.00	2.00	6.30	6.30
364T	33.44	6.12	15.00	---	11.25	6.25	5.88	2.375	5.62	6.25	4.25	8.65	8.65
364TS	31.31	6.12	15.00	---	11.25	4.12	3.75	1.875	3.50	5.00	2.00	8.65	8.65
365T	33.44	6.12	15.00	12.25	---	6.25	5.88	2.375	5.62	6.25	4.25	8.90	8.90
365TS	31.31	6.12	15.00	12.25	---	4.12	3.75	1.875	3.50	5.00	2.00	8.90	8.90
404T	38.31	6.88	16.00	---	12.25	7.62	7.25	3.75	3.50	5.00	6.00	12.50	12.50
404TS	36.31	6.88	16.00	---	12.25	4.50	4.25	2.125	4.00	5.00	2.75	12.11	12.11
405T	36.31	6.88	16.00	13.75	---	7.50	7.25	2.875	7.00	7.50	5.62	12.60	12.60
405TS	35.31	6.88	16.00	13.75	---	4.50	4.25	2.125	4.00	5.00	2.75	12.51	12.51
444T	40.62	8.25	19.00	---	14.50	8.94	8.50	3.375	8.25	8.75	6.88	16.54	16.54
444TS	40.62	8.25	19.00	---	14.50	5.19	4.75	2.375	4.50	6.25	5.00	16.54	16.54
445T	40.62	8.25	19.00	16.50	---	8.94	8.50	3.375	8.25	8.75	6.88	18.00	18.00
445TS	40.62	8.25	19.00	16.50	---	5.19	4.75	2.375	4.50	6.25	5.00	18.44	18.44

- (1) SPECIAL DIMENSIONS APPLYING TO THIS ORDER ON THIS LINE.
- (2) "D" VARIES $\pm 250T - 320T + .00, - .03$
 $\pm 360T - 440T + .00, - .06$
- (3) "U" VARIES ± 625 AND LARGER $+ .000, - .0005$
- (4) ALL FRAMES HAVE EIGHT MOUNTING HOLES FOR DUAL MOUNTING.
- (5) MOTOR WEIGHTS MAY VARY BY 15% DEPENDING UPON RATING.
- (6) "N-W" VARIES $+ .00, - .25$.
- (7) GROUND SCREW HOLE 3/8-16 TAP 1 TO 200 HP ABOVE 200 HP 1/2-13
- (8) AUXILIARY CONDUIT BOX SUPPLIED ONLY WHEN REQUESTED
- (9) MAINDOW PERMISSIBLE SHAFT RUNOUT WHEN MEASURED AND INCLUDING 1.625 DIA AND .0015 TIR BALL BEARINGS .002 TIR. ROLLER BEARINGS FOR LARGER DIAMETERS.

CONDUIT BOX LOCATED ON OPPOSITE SIDE WHEN F-2W-1, W-4-W-5W-7, OR C-1 MOUNTING IS SPECIFIED.
 IF MOUNTING CLEARANCE DETAILS ARE REQUIRED, CONSULT FACTORY.

ORDER: _____ ITEM: _____ HP: _____ CERTIFIED FOR: _____ PH: _____ HZ: _____ VOLTS: _____
 SALES ORDER: _____ TYPE: _____ APPROVED BY: _____ DATE: _____

CUSTOMER IS RESPONSIBLE FOR DETERMINING THAT MOTOR PERFORMANCE IS SUITABLE IN THE APPLICATION.

REV. DESC: EDIT HEADER	VERSION: 02	TDR: 00000453739
REV. LTR: B	REVISED: 16:08:01 01/15/2008	BY: RAGMNL
FILE: \RAG\00005\357		
MTL: -		

BALDOR • DODGE • RELIANCE

DIM SHT TEFC 250T-440TS STD BRKT 841-XL C BOX ON TOP

611760-570-SH2

DUTY MASTER ALTERNATING CURRENT MOTORS
 SQUIREL-CAGE INDUCTION MOTOR
 ENCLASURE: TOTALLY ENCLOSED
 MOUNTING: FOOT
 COOLING: FAN COOLED
 FRAMES 250T THRU 440TS
 841-XL WITH STANDARD OVERSIZED CONDUIT BOX

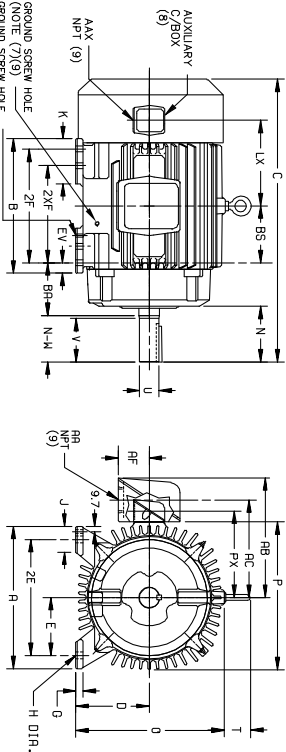

DIMENSIONS ARE IN MILLIMETERS. SEE SHEET 1 FOR DIMENSIONS IN INCHES.

FRAME	A	D(2)	E	G	H	J	K	O	P	T	W(6)	X	Y(9)	Z
254T-256T	317.5	156.8	127.0	191.1	142.6	63.5	---	336.6	336.6	62.0	-1/4	274.6	223.8	63.5
284T-286T	349.3	177.8	139.7	191.1	142.6	63.5	---	374.7	378.0	62.0	-1/2	320.5	258.8	76.2
324T-326T	393.7	203.2	158.8	224.4	175.5	69.9	114.3	423.9	431.8	62.0	2	392.2	298.9	91.9
364T-366T	431.8	228.6	177.8	224.4	175.5	69.9	114.3	469.9	485.3	74.7	3	457.2	350.8	104.6
404T-406T	482.6	254.0	203.2	228.4	206.6	82.6	117.3	541.3	571.5	74.7	3	489.0	392.5	104.6
444T-446T	533.4	279.4	228.6	228.4	206.6	82.6	133.4	593.9	641.4	82.6	3	563.6	443.0	152.4

FRAME	C	BS	B	2F	(2) 2F	N	SHAFT AND KEY	SO.	LGTH	WEIGHT
254T	623.8	127.0	304.8	---	209.6	104.6	101.6	41.28	95.3	9.53
256T	623.8	127.0	304.8	254.0	---	104.6	101.6	41.28	95.3	9.53
284T	697.0	139.7	330.2	---	241.3	127.0	117.3	47.63	111.3	12.70
286T	697.0	139.7	330.2	---	241.3	91.9	82.6	41.28	76.2	9.53
324T	697.0	139.7	330.2	279.4	---	127.0	117.3	47.63	111.3	12.70
326T	697.0	139.7	330.2	279.4	---	127.0	117.3	47.63	111.3	12.70
364T	773.2	152.4	374.7	---	266.7	142.7	133.4	53.98	127.0	15.24
366T	773.2	152.4	374.7	---	266.7	142.7	133.4	53.98	127.0	15.24
396T	773.2	152.4	374.7	304.8	---	104.6	95.3	47.63	88.9	12.70
398T	773.2	152.4	374.7	304.8	---	104.6	95.3	47.63	88.9	12.70
364T	849.4	155.4	381.0	---	285.8	158.8	149.4	60.33	142.7	15.88
366T	849.4	155.4	381.0	---	285.8	104.6	95.3	47.63	88.9	12.70
364T	795.3	155.4	381.0	---	285.8	104.6	95.3	47.63	88.9	12.70
366T	795.3	155.4	381.0	---	285.8	104.6	95.3	47.63	88.9	12.70
404T	913.1	174.5	408.4	---	311.2	190.5	184.2	53.98	177.8	18.03
406T	913.1	174.5	408.4	---	311.2	190.5	184.2	53.98	177.8	18.03
406T	913.1	174.5	408.4	348.3	---	104.6	104.6	53.98	101.6	12.70
406T	913.1	174.5	408.4	348.3	---	104.6	104.6	53.98	101.6	12.70
440T	1038.4	209.6	482.6	---	368.3	227.1	215.9	60.33	209.6	22.23
442T	1038.4	209.6	482.6	---	368.3	131.8	120.7	60.33	114.3	15.88
444T	1038.4	209.6	482.6	---	368.3	131.8	120.7	60.33	114.3	15.88
446T	1038.4	209.6	482.6	---	368.3	131.8	120.7	60.33	114.3	15.88
448T	1038.4	209.6	482.6	---	368.3	131.8	120.7	60.33	114.3	15.88
450T	1038.4	209.6	482.6	---	368.3	131.8	120.7	60.33	114.3	15.88

- (1) SPECIAL DIMENSIONS APPLYING TO THIS ORDER ON THIS LINE.
- (2) "C" VARIES --- 250T - 320T +0, -8
 --- 360T - 440T +0, -15
 --- HP TO 1,625 DIA. +0.00, -0.03
- (3) "U" VARIES --- 1,625 AND LARGER +0.00, -0.03
- (4) ALL FRAMES HAVE EIGHT MOUNTING HOLES FOR DUAL MOUNTING.
- (5) MOTOR WEIGHTS MAY VARY BY 15% DEPENDING UPON RATING.
- (6) "N-W" VARIES +0, -6.4
- (7) GROUND SCREW HOLE 3/8-16 TAP 1 TO 200 HP ABOVE 200 HP 1/2-13, SEE NOTE (9)
- (8) AUXILIARY CONDUIT BOX SUPPLIED ONLY WHEN REQUESTED
- (9) DIMENSIONS ARE IN INCHES

CONDUIT BOX LOCATED ON OPPOSITE SIDE WHEN F-2W-1, W-4W-5W-7, OR C-1 MOUNTING IS SPECIFIED.

F MOUNTING CLEARANCE DETAILS ARE REQUIRED. CONSULT FACTORY.

MAXIMUM PERMISSIBLE SHAFT RUNOUT WHEN MEASURED AT END OF STD. SHAFT EXTENSION IS .03 TIR UP TO AND INCLUDING #22R AND .028 TIR FOR BALL BEARINGS .05 TIR. ROLLER BEARINGS FOR LARGER DIAMETERS.

FRAME _____ TYPE _____ CERTIFIED FOR _____
 ORDER _____ ITEM _____ HP _____ RPM _____ PH _____ HZ _____ VOLTS _____
 SALES ORDER _____ APPROVED BY _____ DATE _____

CUSTOMER IS RESPONSIBLE FOR DETERMINING THAT MOTOR PERFORMANCE IS SUITABLE IN THE APPLICATION.

REV. DESC: EDIT HEADER	VERSION: 02	TDR: 000000453739
REV. LTR: B	REVISED: 16:04:46 01/15/2008	BY: RAGMNL
FILE: \RAG\00005\369		
MTL: -		



DIM SHT TEFC 250T-440TS STD BRKT 841-XL C BOX ON TOP

416820-025

A-C MOTOR
 CONNECTION DIAGRAM
 STANDARD 3 LEAD DELTA CONNECTED

416820-025

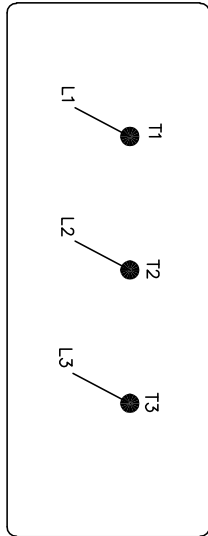
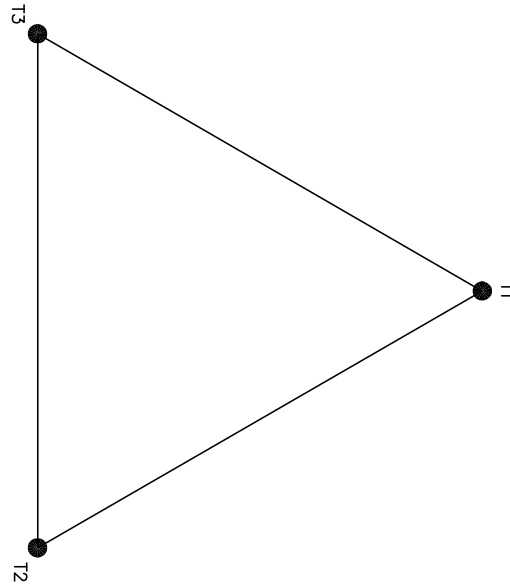

(N.P. 1575-BA)

REV. DESC: REMOVE EXCESS INFORMATION		
REV. LTR: B	VERSION: 02	TDR: 000000477984
FILE: \RAG\00001\809	REVISED: 16:03:29 09/25/2008	
MTL: -	BY: RAGZJR	

Baldor • Dodge • Reliance

CONNECT DIAGRAM STD 3 LEAD DELTA CONNECTED
 SH 1 of 1

REL. S.O.	RPM 1765	S.F. 1.15	ROTOR 418139-37ME
FRAME 286T	VOLTS 460	NEMA DESIGN B	TEST S.O. ---
HP 30	AMPS 36.1	CODE LETTER G	TEST DATE ---
TYPE P	DUTY CONT	ENCLOSURE FCKE	STATOR RES. @ 25 °C .264
PHASE/HERTZ 3/60	AMB °C/INSUL 40/F	E/S 488466	OHMS (BETWEEN LINES)

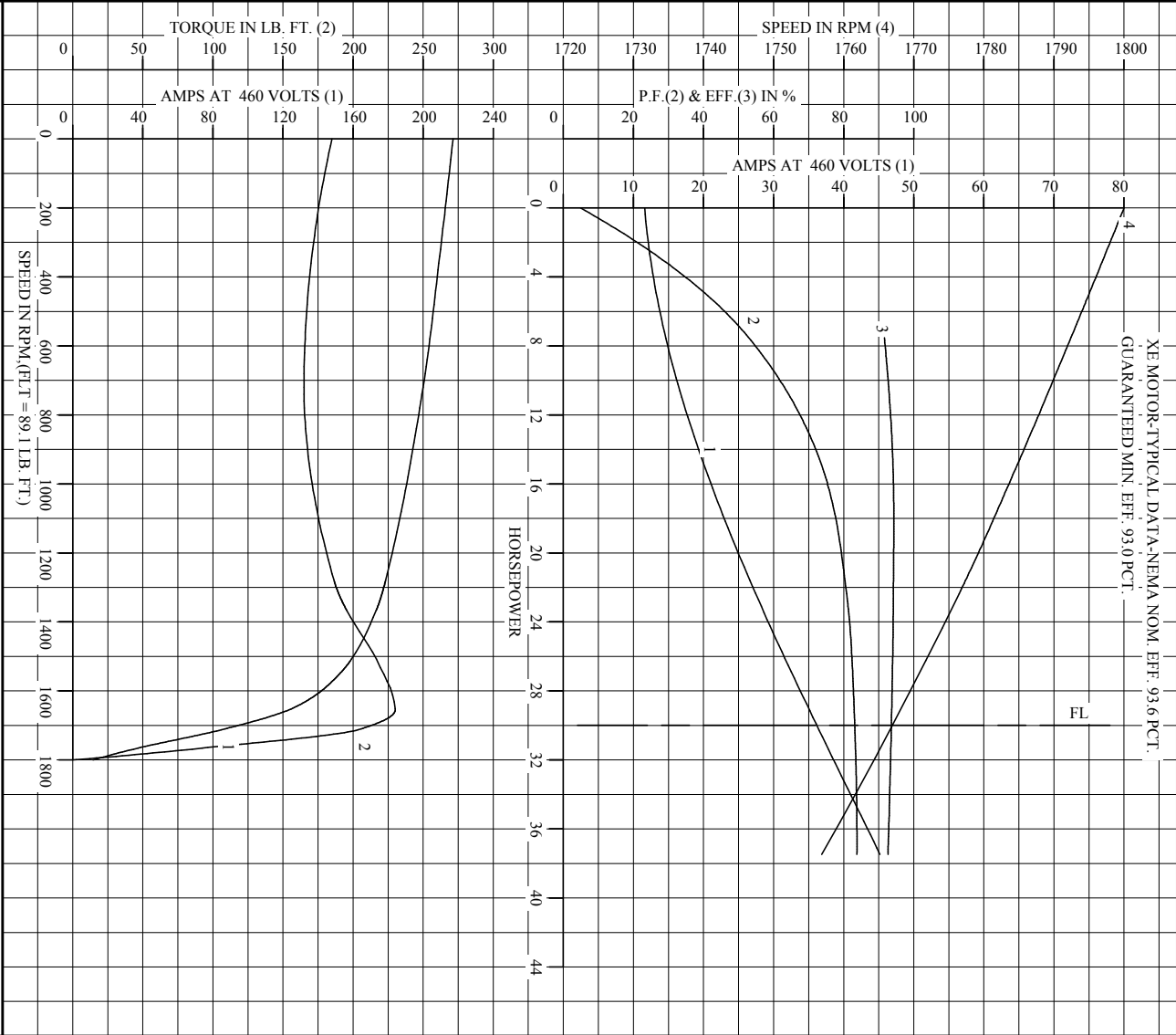

BALDOR
BALDOR • DOUGLASS • RELIANCE

DR. BY P.B. GREENE	A-C MOTOR
CK. BY K.W. KANOUFF	PERFORMANCE
APP. BY K.W. KANOUFF	CURVES
DATE 01/17/95	E09085-B-E011
	ISSUE DATE 01/17/95

Printed on 11/24/08 13:51 @ ragsam

REL. S.O.	FRAME	HP	TYPE	PHASE/HERTZ	RPM	VOLTS
	286T	30	P	3/60	1765	460
AMPS	DUTY	AMB °C/ INSUL.	S.F.	NEMA DESIGN	CODE LETTER	ENCL.
36.1	CONT	40/F	1.15	B	G	FOXE
E/S	ROTOR	TEST S.O.	TEST DATE	STATOR RES. @25 °C (OHMS (BETWEEN LINES))		
488466	418139-37ME	---	---	.264		

PERFORMANCE						
LOAD	HP	AMPERES	RPM	POWER FACTOR %	EFFICIENCY %	
NO LOAD	0	11.6	1800	4.89	0	
1/4	7.52	14.5	1792	52.9	91.6	
2/4	15.0	20.2	1785	73.9	94.1	
3/4	22.5	27.6	1776	80.9	94.2	
4/4	30.0	36.1	1767	83.1	93.6	
5/4	37.5	45.2	1757	83.8	92.6	

SPEED TORQUE						
	RPM	TORQUE % FULL LOAD	TORQUE LB.-FT.	AMPERES		
LOCKED ROTOR	0	208	185	217		
PULL UP	720	185	165	200		
BREAKDOWN	1656	258	230	123		
FULL LOAD	1767	100	89.1	36.1		

AMPERES SHOWN FOR 460. VOLT CONNECTION. IF OTHER VOLTAGE CONNECTIONS ARE AVAILABLE, THE AMPERES WILL VARY INVERSELY WITH THE RATED VOLTAGE

REMARKS: XE MOTOR-TYPICAL DATA-NEMA NOM. EFF. 93.6 PCT.
GUARANTEED MIN. EFF. 93.0 PCT.

 BALDOR • DODGE • RELIANCE	DR. BY P.B. GREENE	A-C MOTOR PERFORMANCE DATA E09085-B-E011 ISSUE DATE 01/17/95
	CK. BY K.W. KANOUF APP. BY K.W. KANOUF DATE 01/17/95	